

Meeting Point



August 2021

TRUE BLUE TAXIS
(OLVESTON)

Local Taxi Company



Honest, Reliable and Safe

Cash or Card Payments



Mobile:

07967 042794

Top-to-Tail Housekeeping

- Professional
- Dependable
- Comprehensive service

**Trading
Standards
Accredited**

**Felina
Contract Cleaning**

01454 201562
07790 050187
cleaning@felina.biz
www.felina.biz



Weddings | Funerals | Bouquets | or just because...

**Beautiful
flowers for any
occasion...**

Our Shop is open Tuesday to
Saturday ~ 9.00am to 5.00pm

Taking walk in and phone orders

Delivering to BS35 and
surrounding areas ~ Tuesday to
Saturday from 9.00am to 5.00pm

Holding socially distanced
meetings for weddings and
memorials should you wish to
discuss plans

Please call for prices or pop into
the Shop in The Arcade,
Thornbury



t: 01454 416111

e: flowers@joliesfleurs.co.uk



**THORNBURY
Chiropractic
CLINIC**

www.thornburychiropractic.co.uk

The Georgian House, 6 The Plain

Chiropractic

Johnatan Williams MSc DC
Carol Williams MSc DC
Joanna Dinham BSc DC

Acupuncture

David Sanders Lic Ac. M.B. Ac.C

Massage

Lucy Luke MTI
Josie Cole MTI (Saturday availability)
**Open weekdays 8.30am-7pm
and Saturday mornings**

01454 418259

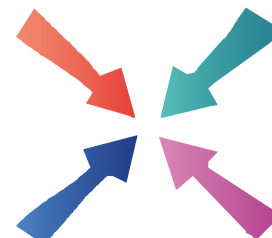

Meeting Point

Volume 45, Number 11, August 2021

The community magazine for the villages of Olveston,
Tockington, Old Down, Lower Hazel, Awkley, Ingst, Aust, Elberton and Littleton upon Severn

EDITOR:

Marelin Orr-Ewing
Courtlands
Olveston
Bristol BS35 4DU
Tel: 01454 610081
[meetingpointeditor@
gmail.com](mailto:meetingpointeditor@gmail.com)

ASSISTANT EDITOR:

Angela Williams
Ashlea
Haw Lane
Olveston
Bristol BS35 4EG
Tel 01454 612850
[meetingpointmagazine@
gmail.com](mailto:meetingpointmagazine@gmail.com)

ADVERTISING:

Bernard Amos
Tel: 01454 620388
[meetingpointadvertising@
gmail.com](mailto:meetingpointadvertising@gmail.com)

Publication date
1st of each month

**Material for September 2021
to the Editor or Deputy Editor
by 9th August 2021.**

From the Editor

This August magazine brings welcome news of upcoming events in the Meeting Point area and beyond. We also hear about local groups which are starting to meet again, including the St. Mary's Coffee Shop – now relocated to the Church from Olveston Stores.

The Tower Restoration Project has reached an exciting stage; I think it is wonderful that we have the opportunity to view one of the newly carved pinnacles close up, before it is lifted high onto the tower.

There are two articles this month that delve into the lesser-known history of our area. One describes a proposed bridge across the River Severn from Aust; a project which was very 'live' back in the mid-1800s. The other describes a 9-hole golf course which operated in Old Down from the late 1800s until around the time of the Second World War. Both make for very interesting reading.

Marelin

This month's cover 'Hollyhocks at Port Farm' is by the late John Crossley

Meeting Point Founded in 1976 by the Anglican and Methodist churches in Olveston, near Bristol.

**Meeting Point magazine and Meeting Point Directory are online at the
Community Website: www.olvostonandaust.com**

Thornbury Motors

- New and Used car sales
- Servicing, repairs and MOTs on all makes



thornburymotors.co.uk 01454 412535



Grovesend Road
Thornbury
Bristol
BS35 2EF



SAVAGE ASSOCIATES

Accountants·Business Advisors
Corporate & Personal Tax Consultants

The Coach House, Aust Road
Olveston, Bristol BS35 4DE
Tel 01454 610388 Fax 01454 201541

for an initial consultation please contact:
edd.savage@savageassociates.co.uk

Vicarage Farm Holistic Therapy Centre

Bringing balance back
into your life.
Offering a wide range of
Holistic Treatments.

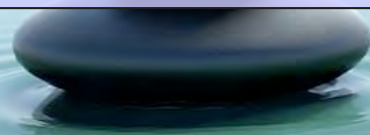

Hypnotherapy

A safe and effective treatment: to
remove stress, anxiety, depression
and phobias. Allowing positive and
powerful changes in your life.

Tel 01454 614390
www.vicaragefarm.org



Olveston Parish Council

Speed Reduction Scheme Gathers Pace

Whether on foot, cycle, horseback, or in a car, no doubt you will have seen the flashing speed monitoring devices and maybe have read articles here in Meeting Point about the local SpeedWatch initiative.

The devices have been in use for several months now, and we are pleased to say that the feedback has been incredibly positive. There is plenty of evidence to demonstrate the valuable impact they are having on speed reduction. Council action on speeding is once again gathering pace. Last month the Parish Council backed the purchase of a second fully owned Speed Sensor and is mounting a renewed push for volunteers to become involved.

Previously the council only had access to a half share in a speed monitoring device, or Vehicle Activated Speed (VAS) sensor as they are more formally known. Earlier this year however, and thanks to the generosity of a local businessman, the council was able to purchase its own VAS device.

One of the main aspects of speed management is the ability to move sensors and to ensure that all access roads can be monitored in rotation. There is a tendency for motorists to ignore them if they remain in one place for too long. A roadside VAS sensor usually stays in place for around three weeks and is then moved to a different location. Using just one sensor would take nearly ten months to fully cover all our roads in both directions.



Councillors Martin Gibson, Tony Turnbull and Miles Grocott installing the new VAS sensor.

VAS sensors are just part of the story however and manual monitoring using handheld radar devices, supplied by the Avon & Somerset Police, are also in use by volunteers from within the community under the SpeedWatch scheme. Together they form a highly effective traffic management and deterrent presence.

Olveston Parish Council is committed to improving the management of traffic in our area. With the addition of the second sensor there is now the ability to double our monitoring capability, provide more data,

D. YOUNG
GARDEN SERVICES
Fully Qualified with over 16 years Experience
Grass Cutting Hedge Cutting Turfing Fencing
General Landscaping

Tel: 01454 416206 Mob: 07545 131488
Email: d.younggardenservices@hotmail.com

hair of the hound
PROFESSIONAL DOG GROOMING SERVICE

- FULL GROOMS
- PUPPY PACKAGE
- NAIL CLIPPING
- DE-SHEDDING PACKAGE
- BATH & BRUSH
- HAND STRIPPING
- EAR CLEANING/PLUCKING
- TEETH CLEANING

Find us : 20 Stode Common, Alveston, Thornbury BS35 3PJ
Tel : 07936 067 107 Web : hairofthehound.co.uk
facebook : search hairofthehound

T. EDWARDS PLANT
Digger and Driver Hire

- Site/garden clearance
- Footings
- Drainage/soakaways
- Driveway preparation
- Stump removal
- Fencing & turfing
- Narrow access equipment

Price or day work t: 07900 372349
t.edwardsplant@gmail.com
CPCS/CITB qualified & insured

Divine
Bathrooms & Wet Rooms

07584 666154
Email: info@divinebathrooms.co.uk
Web: divinebathrooms.co.uk

iphe
Registered Plumber

S.J FARR
KITCHEN FITTING SERVICES

Mobile: 07915673649

Our Associated Services Include:

- Plumbing
- Wall & Floor Tiling
- Decorating
- Plastering

City & Guilds Qualified

Geoff Gulliver
Carpentry & Joinery, Littleton
ALSO
UPVC Doors, Windows and Conservatories. For a very competitive **FREE** estimate

Ring (01454) 414947

enhance reporting and ongoing management, and of course improve safety.

It is all too easy to become unaware of our speed when driving and the impact it can have on other road users, but since the introduction of VAS sensors in the Parish there has been a significant decline in speeding.

Councillor Miles Grocott, who is now leading the scheme on behalf of the council, says "Speed Sensors are helping to make our roads a safe place. Their deployment in the Parish has, so far, reduced speeding by an average of 16%. We would like to thank all those who have already taken part in manual monitoring, but we do need more people to get involved and help make our roads safer places for all."

If you would like to find out more about the scheme and if you are interested in helping, please contact miles.grocott@gmail.com



Back to Reality for the Arts?

There's no better way for the Armstrong Arts Group to re-launch the Thornbury Arts scene than with a spot of Jazz! The AAG has the perfect antidote to Lockdown Blues – a sparkling evening of jazz classics from the Jenner Jazz Quartet, with Gareth Williams (flute and saxes), Sam Foster (keyboard), Jim Pimpernell (double bass) and Jim Sanders (drums).



The jazz evening will take place (maintaining Covid rules) at the United Reform Church on September 11th at 7.30pm. The cost is £12, to include a drink. Tickets are available on 01454 850933.

The AAG is not currently raising funds for the Armstrong Hall but aiming to keep some musical and theatrical events happening in the town. Any monies raised will be used to further this aim.

An October event is in the pipeline and to follow, on 27th November, we can all look forward to Michael Lunts' much awaited 'Christmas Crackers' musical evening. Keep the date, details to come.....

 **2 Men Went To Mow**

All Aspects of Garden Maintenance, Plants & Shrubs Supplied, Garden Rubbish Removal, Fully Insured

Garden and Tree Service Tel: 07956 311901
Local, Friendly and Reliable Email: kev@2menwenttomow.co.uk

Tree Surgery (NPTC Qualified)
All Types of Tree Work Undertaken
Contract Grass Cutting
Beds & Borders Maintained
Pruning and Hedge Cutting
Planting

FREE ESTIMATES!

L. & J. GULWELL

Independent Family Funeral Directors

1 Quaker Lane • Thornbury

Tel: (01454) 418779

24hr Service

email: info@funerals.uk.net www.funerals.uk.net

Private Chapels of Rest

All flooring work and fitting undertaken by experienced professionals

 **Phoenix Flooring Limited**  Friendly and professional staff on hand to help you every step of the way

  **Residential & Commercial Flooring Specialists**

- Carpets • Carpet Tiles • Luxury Vinyl Tiles
- Vinyls • Laminates • Engineered Wood
- Room Size Remnants • Artificial Grass



5 Chelford Grove, Stoke Lodge, Bristol, BS34 6DD
Mon-Fri 8-5pm Sat 9-1pm

Unit 15 Hemingway Business Centre, Walker Way, Thornbury, Bristol BS35 3US
Mon-Fri 9-5pm Sat 9-5pm

COME VISIT US AT ONE OF OUR SHOWROOMS

www.phoenixflooringltd.co.uk Tel: 01454 617723 / 620707 Email: enquiries@phoenixflooring.org

 **COMPANION AND DRIVING SERVICE**

Now taking bookings in your area!

- For people of all ages unable to drive but wish to remain independent
- Supported trips to the doctor, hospital, shops, bank, hairdresser, vet, etc.
- Social outings, holidays, help at home and much, much more
- DBS checked and First-Aid trained
- Dementia friendly
- Wheelchair Accessible Vehicle
- Fully Licensed

To book your Daisy
07951 079 558 / 0333 014 6211
northbristol@drivingmissdaisy.co.uk
www.drivingmissdaisy.co.uk

Connecting Dod to Ulverston: Bridging the River Severn

Nick Fear

For many people, thinking of the Severn Bridge conjures an image of the original one opened in 1966, although this is now perhaps combined with the newer crossing opened thirty years later. Both are magnificent structures and engineering marvels, but at one time there was the prospect of a bridge in the area looking very different to both of the present designs.

In the summer of 1845 newspapers advertised an intention by the Bristol and Liverpool Junction Railway Company to build a bridge, named The Aust Bridge, across the River Severn connecting Aust to Beachley. A provisional committee of planners sought to raise capital by a share release and applications were invited from interested investors. To cover the estimated construction costs, which in 'today's money' would be nearly £249 million, individual shares, costing the equivalent of £6217, were offered. The bridge was designed for railway traffic but would also accommodate ordinary carriages and pedestrians. It would not merely join Bristol to Liverpool, but link to networks covering the rest of the country and even have an ability to reach Ireland.

The advertisement told of the inconsistent ferry service in the area caused by the weather and peculiar tidal issues. It mentioned that the famous civil engineer Thomas Telford had been consulted about a crossing in 1825 and had formed a, 'most decided opinion in favour of it'. Present day engineers were, 'confident of the thorough practicability of the undertaking'. The Admiralty, who oversaw such projects nationally, concluded that 'the value of the project cannot be overestimated'. The esteemed engineer Sir John Rennie, experienced in designing and completing several notable bridge and railway projects, would lead the Severn scheme.

In the spring of 1826, a meticulous survey led to the production of a very comprehensive report by civil engineer Thomas Fulljames, which was scrutinised by James Walker for the Admiralty. In essence the plan was for a series of support towers with carriageways suspended between them. The total length of the structure covered a distance of 5422 feet, just over a mile. Although the drawing showed three main towers, flexibility had been built into the calculations, offering two plans for different numbers of towers and openings. At either end abutments to the land were detailed. At Beachley this consisted of an arched structure with one tower. At Aust, due to the height of the cliffs, this was much larger and followed the design of the main towers. The abutments were pinned to the land, the support towers were grounded on



Tel: 07887 652358
Jed's N.E.A.T. Services
(Nose Everything About Technology)



Technology brings us together and makes life easier. But.....

What should you buy?

How does it work?

And what if anything goes wrong?

Phones / laptops / tablets / TV's / Smart home systems. I can.....

- Help you choose what's right for you
 - Teach you how it works
 - Fix existing 'tech' problems

HOME VISITS – VIRTUAL REMOTE ASSISTANCE – PERSONAL SHOPPING

PRICING POLICY – Please pay me what you think is fair – SIMPLE 😊

ABOUT ME

Jed Williams – I'm 16 years old, live locally & have had my own business for over 3 years

Email: me@jedwilliams.co.uk Website: myneat.co.uk Tel: 07887 652358

Top quality Nursing and Residential Care



Beech House

Beech House Care Home provides excellence in all aspects of care for all our residents, offering the best in nursing care for the elderly and residential care for people with a diagnosis of dementia.

Our unique care service includes:

- beautiful gardens
- purpose built homes with 24/7 air circulation
- spacious rooms and wide corridors
- top quality chefs
- television with DVD and telephone in each room
- wheelchair provision at no additional cost
- high technology baths and walk-in showers
- regular minibus trips
- programme of interesting and stimulating activities



To arrange a visit, telephone 01454 412266
For more information see www.bristolcarehomes.co.uk

Bristol Care Homes
providing a unique care service

several principal rocks in the area, Ulverston, Lower Bench and Dod. These

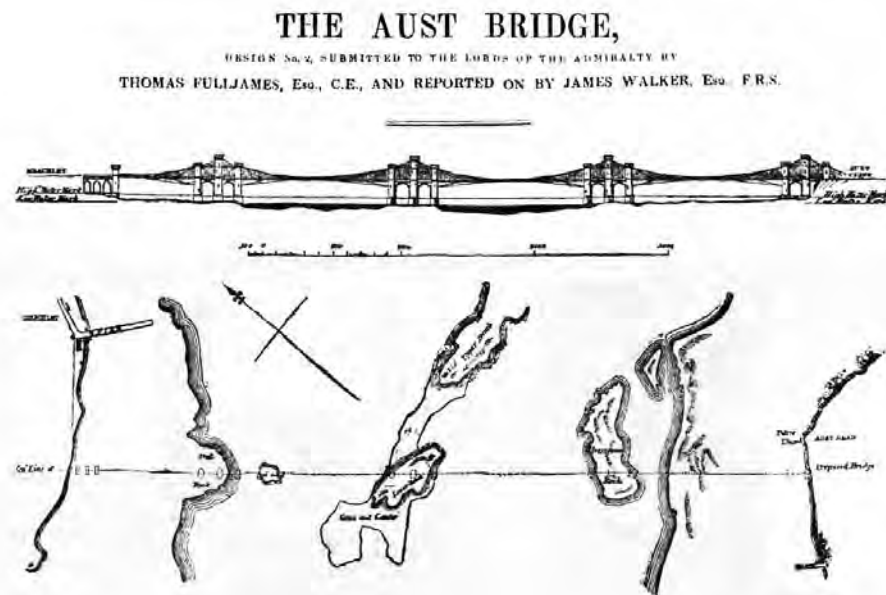

were made of hard limestone rock and found to be capable of supporting the structures. The whole bed of the river was made of solid rock.

The counsel of local people who knew and regularly used the waterway had been taken. The central opening, in the area of the rocky outcrops of Lower Bench and Goose and Gander, would accommodate even the largest vessels which plied their trade on the Severn. Concerns about access to existing piers and into the River Wye on the Beachley side had been answered. The unusual currents, tidal ebbs and flow with such a difference in water height was accounted for and seen as an advantage. Construction work at low tide would be easily managed and lead to lower overall costing. The report estimated that a population of eleven million would benefit from the bridge, 'both in personal intercourse and the exchange of their goods'. A helpful drawing of the bridge was included, portraying a venture which, 'was of national interest'.

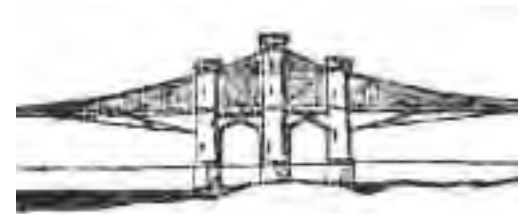

The Lords of The Admiralty responded that the account was a, 'comprehensive report' and gave their assent to the principle of the proposed

www.olvestonpreschool.co.uk/pilning-site



...a wonderful place to grow!

Pilning Pre-School



NOW OPEN!

Offering amazing childcare to children aged 2-5 at the heart of our local community.

Pilning Village Hall
Open 9:00am - 3:00pm
Tel: 01454612074

Find us on Facebook

bridge. 'We may fairly add that both of Mr Fulljame's designs, and magnificent structures, unite elegance with solidarity and bold as they are, convey to the mind an impression of safety'. The scheme was debated by a select committee of the House of Commons which reached agreement on the need for a passage over the Severn. In particular it mentioned the benefits for The Royal Mail generally, and the prospect of improved connections to Ireland. All seemed set for positive progress, but information on this is scant, almost invisible, and time went by.

In 1846 the country was at the peak of a period some historians call 'railway mania'. There were at least 272 railway projects underway which had been approved by Acts of Parliament. There was a growing dominance by the Great Western Railway in our area; its 1845 plan to bridge the Severn much nearer to Gloucester had been abandoned after this had been turned down by The Admiralty. Other railway companies in the region were in competition with each other, the Bristol and Liverpool Junction being just one. Links to the crossing were found to be problematic and not as easy as had been predicted. There were different railway track gauges with corresponding issues for rolling stock. Even if there was a will to connect to the Aust Bridge project, in some cases this was just not practical. The original scheme costing was found to be optimistic and new estimates were not encouraging. The South Wales Railway Company began to grow to the north of The Severn, serving the profitable coal trade and village communities alike. Other railway plans were more attractive and produced ready annual profits. The take up of shares for the Aust Bridge seems not to have been as high as had been hoped for. Investments were lost and promises of rich returns broken. Once again time slid by.

As the plan for the first Aust Bridge was slowly consigned into history, the G.W.R. did cross the Severn in 1886, with the opening of the famous railway tunnel. This had taken a considerable amount of time, 13 years, to complete. But would the Aust Bridge have taken less? We will never know. It took a further 120 years for the first bridge across the Severn to connect the shores via Ulverston and Dod, and this took five years to complete.

Had Aust Bridge ever been completed one wonders if it would have lasted to the present day, with safety, design and technological innovations undreamt of by the original planners. Of its time, it would have been a breathtaking, soaring sight and would undoubtedly have been visited for its own sake.



XL Plumbing & Heating Solutions Ltd

- General Plumbing
- Boiler Installation, Servicing & Maintenance
- Gas Safety Certificates
- Bathroom Installation & Tiling

Contact Mark Mob: 07738 726803
Email: xlplumbing@hotmail.co.uk
Tel: 01454 549008
Web: www.xlplumbing.co.uk



 **PawsPetCare**
...simply for the love of animals

Providing care for your pets
when you need it

Contact Helen for a friendly and reliable service
07493 153520 or enquiries@pawspetcare.com
www.pawspetcare.com

Frontline Martial Arts

Traditional Martial Arts / Taekwondo

Mighty Mites (under 10's): Fridays 4.30-5.15pm at
Juniors (ages 10-13): Mondays 7.15-8.15pm
Adults/over 13's: Mondays 8.15-9.45pm
at Alveston Youth Centre



Tel: 07771 692222
www.frontline-ma.co.uk

THE WHITE HART INN Olveston



Traditional 17th Century English Pub

Catering for Parties and Functions
Wide variety of cask & keg beers
Skittle alley & pool table available
Book now for Skittle Matches
Award winning courtyard garden

Telephone: 01454 612175

Old Down Cricket Club

Tony Gardner
07889 727729

150 Club Winners July 2021:

£50 John Cryer
£15 Simon Walker
£5 Bill Finch

Latest £25 Bonus Ball Winner:

19/06/21 Richard Panes
03/07/21 Dave Gardner

August Fixtures at The Park (Start 1.00pm)

07/08/21 1st XI v Frenchay
14/08/21 2nd XI v Oldfield Park
21/08/21 1st XI v Stapleton
28/08/21 2nd XI v Whitchurch

Up the Down!

Friends of St. Mary's

The prize winners in the July draw, held on 8th July 2021 were:

Amount	Number	Name
£150	570	Mr R Lloyd, Tockington
£75	388	Mrs S Shaw, Olveston
£25	250	Mr & Mrs R Williams, Olveston
£25	590	Mrs S Roos, Olveston
£25	311	Mr & Mrs A Maunders, Newquay
£20	609	Mrs M Shurmer, Olveston
£20	566	Mrs M Shurmer, Olveston
£20	198	Mr D Jeckells, Olveston
£20	331	Mr J Mason, Tockington
£10	258	Mr H Pearce, Ingst
£10	607	Mr L Harper, Olveston
£10	486	Mrs C Phillpott, Tockington

If you are not yet a member and wish to join the lottery, please telephone
Andy Phillips on 01454 614890 or email: andisp28@hotmail.co.uk.

Don't forget, if you're not in – you can't win!

SO SMART

Cosmetic Paint & Alloy Wheel Refurbishment

www.sosmartalloywheels.com

Bumper scuffs
Machine polishing
Minor panel damage
Kerb Damage
Fully Refurbished



Mobile Service available for Alloy Wheel Repairs

M: 07816526304
E: sosmart2k3@aol.com
Based in Almondsbury, South Glous

FRANCIS

DESIGN & BUILD

Carpentry & Building Services

For all aspects of carpentry

Doors, Skirting, Kitchens, Fencing,
Decking, Stairs, Timber frame etc.

Call Craig on 07970 514409
(or, if busy)

email: craigyoung0308@live.co.uk

Severnside Heating & Plumbing



- Installations
- Servicing
- Repairs

Working locally since 2003. An experienced heating and plumbing engineer. For a no obligation quote please call Mike
Mob: 07554 825813 Tel: 01454 613780



Sockets, Lights, Security Lighting, Landlords Reports, Inspection & Testing, Consumer Units, Electric Heating, Rewires, New Builds, Garden Electrics, Car Charging Points, Solar PV, and More..

Your Local Electrician Richard Corney



01454 633 336
laelectrical.com



GARDEN AND GROUND MAINTENANCE

- Stump grinding
- Tree pruning & removal
- Hedges & shrubs trimmed
- Grass cutting
- Fencing
- Turfing
- Garden clearance
- Spraying for weed control
- Patios power washed
- Gravel areas laid

For a no obligation quote please call Chris Till on
07971 460239 / 01454 851771
or visit raysgardenservice.co.uk



**"The Friendly pub
where you arrive as
our Guest and leave
as our Friend"**

BOARS HEAD AUST

01454 632278

- Your local friendly Village pub
- Open 7 days a week
- Food Served from 12.00pm to 9pm every day
- 1st Friday of the month is Quiz Night
- Breakfast Available
- Chefs Table Food Experience
- Parties Catered for
- Open Log Fires
- Real Ales and Premium drinks available
- 5 star Food Hygiene rating

MAIN ROAD, AUST, BS35 4AX

Olveston and Tockington WI

After months of keeping in touch by Zoom, WI members have been really pleased to start meeting up in person. We are having open air coffee mornings and afternoon teas and have also started a walking group following the footpaths around the parish. So far we've been very lucky with the weather!

Our July WI meeting was in a member's garden and after the holidays we intend to start our regular evening meetings in the Parish Hall, with the first date being Tuesday 13th September @ 7.30pm. We have wonderful entertainment planned for it! If you would like to join us for any of our meetings you will be most welcome. We are a village group, but our organisation has a national reach. If you are interested, please contact Angela Green on 615222 for more details.

Royal British Legion Women's Section, Olveston Branch

We are planning to resume our meetings at Daldry Gardens in September. Meanwhile, on August 3rd, we have afternoon tea arranged for our members in our chairman's delightful garden at Tomorosa. This is the centenary year of the Royal British Legion, and we are looking forward to resuming our fundraising activities in support of British Armed Services and their families.

Severn Vale Flower Club

Severn Vale Flower Club is about to return. However, we have changed our venue and in future will be meeting at St. Mary's Church Hall, Eastland Close (off Eastland Road), which is situated past Thornbury Health Centre. The Hall has its own car park and there is a bus stop nearby.

From September we will usually be meeting on the third Monday of the month (unless otherwise stated), rather than the third Wednesday. We are looking forward to welcoming all our members and friends back. If you are not already a member and are interested in flower arranging, you are invited to come along and join us.

Our first meeting is on Monday 13th September at 2.15pm, when our flower arranging demonstrator will be Jenny York. Hope to see you then.....

**FOR ALL YOUR
PRINTING AND
DESIGN NEEDS**

motion
motiondesign&print

01454 631289
Based Severn Beach

BUSINESS CARDS
HEADED PAPER
NCR SETS & PADS
FLYERS & LEAFLETS
BANNERS & POSTER
CORREX PRINTING
BROCHURES & FOLDERS
GRAPHIC DESIGN
WEBSITE DESIGN

info@motionprinting.co.uk
www.motionprinting.co.uk

ACE1
Window & Gutter Cleaning
Window Cleaning
Gutter Cleaning & Repair
Fascia & Soffit Cleaning
Conservatory Roof
Solar Panel Cleaning
Power Washing



M: 07590 201264
T: 01454 436162

ALMONDSBURY PHYSIOTHERAPY AND SPORTS INJURY CLINIC

Louise Brinson

Chartered Physiotherapist, hpc reg

Almondsbury Surgery, Sundays Hill
Almondsbury, BS32 4DS

Tel: 07786915442

Fax: 014540615745

E-mail:

physiolouise@hotmail.co.uk

Also at Aztec Spa Leisure Club

Olveston and Tockington

Parish Hall
07780 515317

A great venue for :

- Fitness
- Parties
- Public events
- Music & Dance

Check availability & book online at www.olvostonparishhall.co.uk

"Our newly decorated Hall"



The Open Garden

Peter Floyd



"Welcome to our garden"
We know our guests are happy.
As they look around them
At flowers so bright and healthy.

Gardeners know it's not like that,
The winter was a bore,
The spring flowers they were lovely,
You should have come before.

The sun shines even hotter,
So it soon begins to harden,
We've no longer any rainwater
To freshen up our garden.

The pests and the diseases
Wreck the veg we hope to eat.
But we don't like using poison
The nasties to defeat.

The birds eat almost any fruit.
The squirrels eat the nuts.
The rabbits eat the vegetables
And the slugs attack our roots.



We recently transplanted
Lots of homegrown leeks.
'somebody' has dug them up.
It makes you want to weep.

Just in case you think that's all
That could possibly displease,
The local herd of pretty deer
Have browsed our Christmas trees.

There's many a seat in our garden,
But never do we sit.
The constant heavy labour,
I suppose it keeps us fit!

The early flush is over,
You missed a glorious show,
The summer flowers will soon be out,
Come then – we'll let you know.

June 2021

Bristol Carriage Masters

- Religious or non-religious funerals
- Bespoke funerals for burial or cremation
- Fully guaranteed pre-paid funeral plans
- Direct cremations



177 Crow Lane, Henbury, Bristol, BS10 7DR
Telephone: 0117 950 8066
Website: www.bcm-funerals.co.uk
Email: admin@bcm-funerals.co.uk

Windmillcare Homes

— great places to Live



Windmill House

The original, elegant home in a delightful rural setting with 2 acres of beautiful gardens delivering unrivalled care

01454 413818



OSBOURNE COURT

Our brand new purpose-built home providing exceptional specialist dementia care in the heart of the village of Stoke Gifford

0117 944 8700

Residential, Short-term Respite and Day Care available

enquiries@windmillcare.com

or www.windmillcare.com

'Indawes - Outdawes'

Decorating and Home Improvements

Painting | Wall Papering
Floor Laying

Martin Dawes 07720 509653
martin.dawes@live.com

**ROG SKUSE
PAINTER AND DECORATOR**

FOR ALL YOUR
INTERNAL AND EXTERNAL DECORATIONS

CALL ROG
ON
07870459771



Greenforce

Did you Know?

..... that Metaldehyde, which is used as slug bait is to be banned as from next year? This pesticide has been causing the real decline in our population of hedgehogs.

.....that UK coal will no longer be burnt for electricity as from 2024?

.....that Sainsburys is making a positive effort to recycle certain plastics? Check on their website for details.

.....that approximately 267 million people in the world live on land that is less than 2 metres above sea level? Scientists predict that by 2100 that number will increase to 410 million if the sea level rises by only 1 metre. If high greenhouse emissions continue to be uncontrolled worldwide, the sea level could rise by 1 metre by 2100. The flood defence bank along the River Severn is being raised from Severn Beach to Aust. This is a big engineering project, which surely sends us signals for the future regarding the warning about rising sea levels.

- All makes servicing and repairs
- Petrol and Diesel MOT Testing
- Tyres, Exhausts and Batteries
- Air Conditioning
- Latest Bosch On-Board Diagnostics
- Vehicle Sales



New Road, Olveston, BS35 4DX

01454 202030

the Good Garage Scheme





Tel: 01454 885766
Mob: 07724 166917

Ridge Roofing and Property Maintenance

Roofing ❖ Chimney Repairs ❖ Lead Work
Guttering ❖ External Painting
General Maintenance ❖ **FREE Estimates**



DOMESTIC APPLIANCE REPAIR SPECIALIST

- WASHING MACHINE
- TUMBLE DRYER
- DISHWASHER
- FRIDGE FREEZER
- COOKER
- HOB OR HOOD

Fast, friendly and efficient service
Sales - Service - Repair

Tel: 01454 850522 - Mobile: 07917441539
Email: d-cr@live.co.uk - Web: www.d-crdomesticappliances.co.uk

Proud member of: 



- VEHICLE VALETING
- PAINT RECTIFICATION/MACHINE POLISHING
- CERAMIC COATING SPECIALISTS
- BASED IN OLVESTON
- FULLY ACCREDITED/INSURED

Tel: 07852 127772
www.gr8cars.co.uk
GR8cars@hotmail.co.uk



What is Ceramic Coating?
Ceramic coating is a long-term nanoscopic automotive paint treatment and protectant that is applied in a liquid form and cures to form a hard layer on top of the paint. It protects a car's paint from blemishes and damage while keeping it cleaner for longer. After application, it also makes car washing easier and shields the car from harmful UV rays. Ceramic coating creates intense water beading and dirt run-off and gives a car an extremely glossy shine.

SPIT'N'POLISH

CLEANING SERVICES



ALL TYPES OF DOMESTIC AND COMMERCIAL CLEANING UNDERTAKEN IN OLVESTON AND SURROUNDING AREA

Specialist equipment including

- Floor scrubber
- Carpet/upholstery cleaner
- Domestic & Commercial steam cleaning equipment.
- Professional Pressure washer

Deep cleans, End of Tenancy Cleans, Sterilisation cleans, window cleaning, weekly cleans, all jobs considered.
Patio/driveway cleaning also available

CONTACT MARTA ON 07785 180802

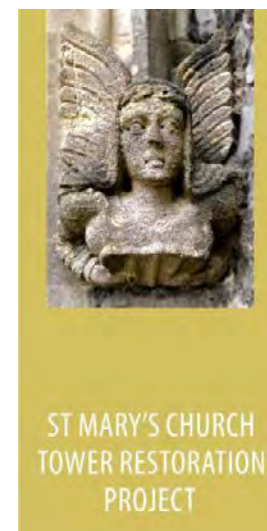

St Mary's Church Tower Restoration Project

Peter Floyd

Things are happening at last!

The photo, below, shows the first pinnacle which has been carved and delivered to the church, where it can be seen just inside the main door on the right. Mark Hancock, the sculptor, hopes to finish it in the church, demonstrating to local school children and those who are interested, how stone carving is done. Once the scaffolding is up and the existing pinnacles are brought down, he will re-erect one beside the new pinnacle for comparison. The old pinnacles will be for sale to anyone who would like to have them.



LINELA

embroid | print | promote

One place for everything promotional.
Specialising in embroidery,
printing and branded gifts



T Shirt Printing
Sports wear
Work wear
School wear
Promotional Products

Call us: 01454 615300

Email us: sales@linela.co.uk

www.linela.co.uk

BonneFreshClean

Carpet & Upholstery Cleaning Specialists

Love the look and smell of
clean and fresh carpets and
upholstery?

Bonne Fresh Clean brings to
you a professional carpet and
upholstery service that will
leave them sparkling and fresh.

Call for a free
no obligation
quote today!

- Thorough, gentle deep cleaning, no residues
- Child and pet friendly treatments
- Latest industry approved qualification and full insurance



Bonne Fresh - Relax and enjoy beautifully clean
and fresh carpets and upholstery!

T: 01454 436001 M: 07774 908410

W: www.bonnefreshclean.co.uk

44 Townsend Lane, Almondsbury, Bristol, BS32 4EQ



Livewire Electricals
Electrical & Mechanical Solutions



Domestic, Commercial
and Industrial Installations

All electrics for new build, extensions and
alterations to satisfy mandatory Building
Regulations. Landlords safety inspections
Portable Appliance Testing (PAT)

Electrical and electronic service and repair
For 24 hour call-out service available please
call Peter Jones: Tel: 07880 858785

Email: pete.livewire@blueyonder.co.uk

Local number Tel: 01454 613482

Visit our web site at

livewire-electrics.co.uk

Rubbish problems?



Clearance from
Garages
Houses
Offices
and much more.

Call Nigel
01454 529 003

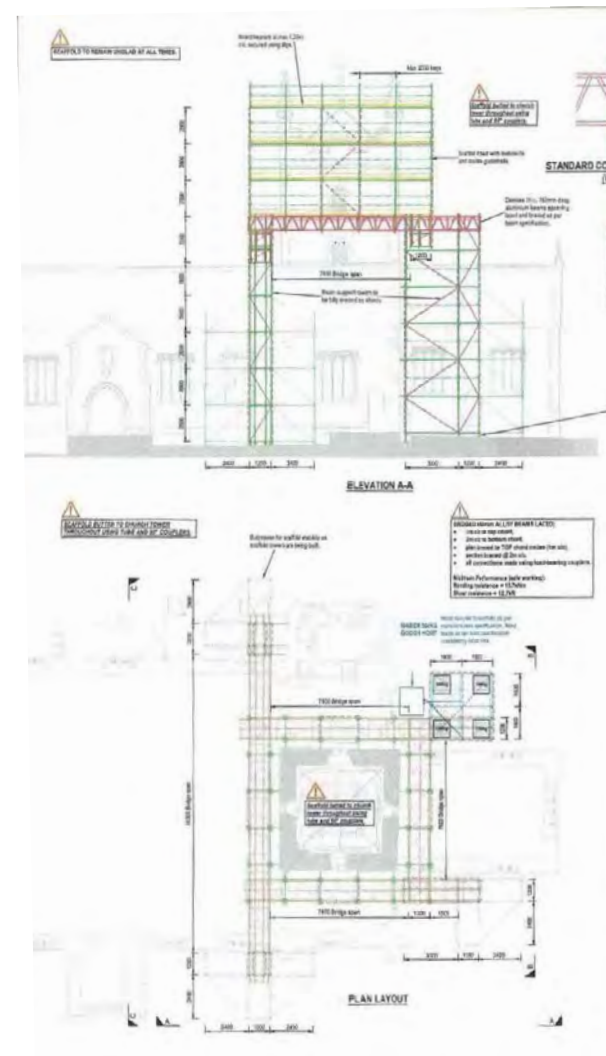

This diagram shows how
complex the scaffolding
design is and why it will
cost about a quarter of
contract price!

The plan, designed by a
specialist scaffolding
engineer, shows 4
towers rising from
ground level outside the
church, supporting 4
bridges surrounding the
church tower and
spanning across the
church rooves, which
would not be strong
enough to take this
superimposed weight.
The elevation drawing
shows the scaffolding
going right up to the top
of the tower in 9 stages.

The northwest scaffold
tower will land inside the
present shed, which will
have to be reroofed. The
southwest tower lands
between the south and
southeast doors to the
church. The southeast
tower has been extended
away from the south
aisle and specially
braced to avoid a
complex of tombs and

the northeast tower is four times the size as the others to support the 500kg hoist, which is needed to take the heavy stone blocks up to the level of the tower parapet. The hoist will come down by the vice turret door, which will not be needed since neither clock nor bells will be in action during the restoration contract, partly because of the noise and partly because the tower moves when the bells are swung.

You have read a great deal about this complex and expensive project and may reasonably have thought that nothing was happening. It is often said of

Beauty at the Barn

4, Grey Gables, Vicarage Lane, Olveston
For appointments telephone Nicola on
01454 201717



Jessica Manicures
GELeration Nails
Shellac Nails
Jessica Pedicures
Spray Tanning
Waxing
Ear Piercing
Eyelash Perming
Eyebrow Shaping
Eyelash tinting
And more...
Evening appointments available
Gift vouchers available



Olveston & Tockington Tennis Club

"Your local tennis club, next to Olveston Parish
hall"

**Make 2021 the year to get back
on court.**

Coaching for all ages.

**Fabulous clubhouse with changing
facilities, kitchen, TV and table tennis.**

Call Martin 07720509653

Everyone welcome



LOCAL TO ALMONDSBURY

T: 01179 692817

M: 07974 088147

E: breed.bins@yahoo.co.uk

**Commercial and Domestic Skip Hire
& Aggregate Supplies**



MD Aerials

Call Michael Dagger



T: 01454 418 341 M: 07817 304 236



Freeview – Freesat – Sky – DAB Aerials

Wall mounting LCD & Plasma
televisions setting up & tuning



mike@mdaerials.co.uk
www.mdaerials.co.uk

MOBILE BEAUTICIAN

(Based in Olveston)

- Waxing
- Shellac coloured gels
- Massage
- Manicures
- And much more!
- St Tropez Spray Tanning
- Ear Piercing
- Facials
- Pedicures

All available in the comfort of your own home
and better than salon prices!

Call Katie 07707 021195

www.kbeauty.co.uk



RB Foot Health Clinic
Professional Mobile Foot Health Care

...footcare in
the comfort
of your own home

For the professional
treatment of

**Callus
Corns**

Cracked Heels

Fungal & Thickened Nails

Ingrowing Toe Nails

Toe Nail Cutting

Contact Rachael
Mob: 07760 595224
info@rbfoothealthclinic.co.uk
www.rbfoothealthclinic.co.uk

Rachael Button - DIP SAC MPS PRACT QUALIFIED NURSE

building projects that nothing is happening until the scaffolding goes up. Well, it should be up by now and we hope you will at last be able to see some real action.

Appeal Update

David Prothero, Treasurer, St Mary's Church, Olveston

The total amount raised for the Tower Restoration Project now stands at £219,500, which means that we need just another £3,500 to cover all eventualities. A massive 'thank you' to all in the local community (and beyond) who have donated so generously in response to the Appeal. If you would still like to help, donations can be made in one of the following ways:

By bank transfer to the St Mary's Church bank account, the details of which are: Sort Code: 40-52-40, Account Number: 00029936, using the reference "Tower Project".

By cheque made payable to "St Mary's PCC Olveston", and sent to David Prothero, Treasurer, St Mary's Church Olveston, Rose Cottage, Buckover, Wotton-under-Edge, Gloucestershire, GL12 8DX.

If you wish to Gift Aid your donation, please e-mail me at dlprothero@talk21.com. Once again very many thanks to all who have supported this project.

More about the Littleton Cider Orchard

Martin Gibson

I enjoyed reading Jim Turton's article in July's Meeting Point, which told the story of the Littleton Cider Club as it approaches its 10th Anniversary. Back in the 1990s I was very much involved in turning the field behind the White Hart pub into an orchard, and so I am offering a bit of extra historical background and hope to clarify a couple of details about the very early days of this project.

From 1989 to 1993 I was the owner of Long Ashton Cider Ltd., and I was also an allotment holder in Olveston. I had over 400 cider apple rootstocks growing there and, with help from an expert from the Long Ashton Research Station, grafted on some 18 different cider apple varieties, including Kingston Black, Dabinett, Yarlington Mill and Brown Snout. These varieties were chosen by the world's leading expert in cider varieties, Mr Ray Williams, also from the Long Ashton Research Station. The intention was that these specific varieties would, when blended, produce a very drinkable cider, even though cider apple trees were particularly biennial in those days.



Delivering the highest standards of homecare in South Gloucestershire for 14 years

Premier Homecare is the leading homecare provider in North Bristol and South Gloucestershire, having cared for over 2,000 families, ensuring they are safe, healthy and looked after

- Short and long term home help
- Flexible hours
- Bespoke care support
- Highly trained and reliable carers
- Personal Care
- From cleaning to 24 hour Live-In care

Inspected and rated
Outstanding ☆
CareQuality Commission

good care guide
★★★★★

Great British Care Awards
2016 WINNER

Call today for help with a loved one

PREMIER HOME CARE

0117 959 2013
www.premier-homecare.com



el cuisine

Catering for any occasion
Private parties, Birthday and Anniversary Celebrations,
Weddings, Funerals, Corporate Events,
Formal Dinners, Shoot Lunches... whatever the occasion

www.el-cuisine.co.uk Please contact Emma 07931952939 info @el-cuisine.co.uk



Tockington Manor School and Nursery
for boys and girls aged 2 to 13 years

We're open for socially-distanced private tours

Come for a tour and discover our small friendly classes, enviable success rate in securing senior school places, wrap around care and dedicated nursery facilities.

If you're considering a school place for your child in September 2021 please contact us to arrange a private tour.

Call to book your private tour or 1:2:1 video call: 01454 613229

TOCKINGTON MANOR SCHOOL AND NURSERY
TMS

The field at the rear of the White Hart was untended when, in 1991, I agreed with Ian Williams, the then owner of Smiles Brewery and the pub, that I could have it for a peppercorn rent and convert it into an orchard. I asked Harding Bros. to harrow it and, in 1992, I planted all the rootstocks taken from my Olveston allotment. The trees grew well, although there was a drainage issue affecting a score of trees on the north-western boundary. The first fruit was collected around 1996 and taken to Roger Wilkins' Cider Farm in Somerset for pressing. The cider went to Smiles Brewery's estate, including the White Hart.

In 1998 the White Hart underwent extensive building works, involving the removal of rocks and concrete which were taken to the bottom of the orchard. On the way there, however, much of the debris ended up in the orchard and when grass cutting time came around my machinery was broken by all the rubble. Sadly, neither I nor Smiles had any spare money at that time, so the orchard was abandoned. Shortly after this Smiles sold The White Hart. Later, in the 2000s, a group of parishioners, led by Bob Slade and Neil Harvey, took over the orchard, tended it and bought the machinery Jim Turton refers to in his article, which led to the formation of The Littleton Cider Club.

Over 60s Tea Room



The Over 60s Tea Room in Thornbury High Street is run by volunteers, as an informal café for older people to meet up and chat over a cuppa.

We are now able to open four days a week: Monday, Wednesday, Thursday and Friday from 10am to 2pm. We serve a variety of hot beverages at

50p a cup, as well as squash and other drinks. We sell biscuits and sometimes cake, but you are welcome to bring along your own food.

You can find us at the side entrance of the Town Hall. Everyone over 60 is very welcome to drop in for a chat in our friendly tea room, which now looks better than ever. It has been completely refurbished, thanks to the support of local organisations who also helped us to pay for the necessary hand sanitisers and hygiene measures.

Natalie Gladstone BSc(Hons) Ost

OSTEOPATH

Back & neck pain, arthritic / joint pain, sports injuries, pre / post natal, whiplash, cranial treatments, rehabilitation Pilates.

Tel: 07870 219 249

www.nataliegladstoneosteopath.co.uk

OLD DOWN HILL, TOCKINGTON

Easy parking. Day & evening appointments.
REGISTERED: EXPERIENCED: PROFESSIONAL



Digger and Driver Available
Out-Door Services

A. D. D. PLANT

Groundwork, Digging & Clearing
Turfing, Any outdoor work

Tel: 01454 417372

Mobile: 07866 407683



keeping your garden
beautiful...

ask us about
LAZYLAWN

- LazyLawn - superior artificial grass supply and installation - licensee for Bristol & South Wales
- landscape design and build with 25 years experience
- tree surgery
- garden makeovers
- regular garden maintenance

**Garretts Gardens
and Landscapes**

for Garretts Gardens or Landscapes
t 01454 614111 m 07974 109919
info@garrettslandscapes.co.uk
www.garrettsgardens.co.uk

Come rain or shine,
lisa costa estate
agents have the
experience and
knowledge to take
you smoothly through
the moving process.



lisa costa

RESIDENTIAL SALES & LETTINGS

53 High Street | Thornbury | BS35 2AR
01454 279734 | sales@lisacosta.co.uk | lisacosta.co.uk

Please note: If your property is currently on the market, the terms and conditions of your Existing agency agreement must be considered before instructing ourselves.

The Old Golf Course at Hazel

Peter and Tessa Floyd

Although many of us walk across the top of The Down above Lower Hazel, most have no idea that this was once a 9-hole golf course, which has always appeared to occupy the two areas of downland above and below Hazel Lane, but surprisingly perhaps, it actually extended down into the now arable Sheepcombe valley.

The history of the Golf Course is obscure. Thornbury Roots website describes it as Alveston Golf Course (though that doesn't sound right) and reports a golf match in 1894 between Thornbury and Henbury, including both ladies and gentlemen. A land sale plan of 1888 shows the land was part owned by the Ward and Crossman families and this change of ownership may have enabled the creation of the golf course, including the upper part of the Sheepcombe valley, then planted with parkland trees and grassland like the hillside above.

By 1928 a plan (possibly another land sale and shown on the Thornbury Roots website) showed it as a golf course, with the hillside part of the course below Hazel Lane owned by the Crossman estate, which was sold to Percy Rogers who lived at Rudgeway. The rest of the surrounding land appears to have been owned by the Ward family, whose descendants still own it today. On that plan, the club house was shown below the lane between Lower Hazel and Sheepcombe Farm (the site of Green 1 on this plan) suggesting that perhaps the original golf course might have been laid out differently.

It was a basic course but had a greenkeeper called Albert Down. Local historian Eric Garrett remembers, as a boy, biking over to hunt for lost golf balls with his friend Trevor Watkins, and understood that it closed during the Second World War for lack of them. He also believes that a former member maintained the Hole 7 green for putting practice into the 1950s. Richard Tovey confirms that his father bought the wooden club house as a sports pavilion for Tockington Manor School when it opened in 1946.

At the end of the Second World War the course was threatened with development, or the possibility of quarrying, so the surrounding householders clubbed together to buy the parts above and below Hazel Lane, as the 'Hazel Landowners'. Shares in the golf course land were attached to the houses rather than to their owners, ensuring the land remained together and that it would continue to be looked after. Today there are footpaths across the Down which are shown on the 'Olveston Parish Walks' leaflets.

Like much historical research, this is all very confusing, but we hope it may be of sufficient interest to others who might wish to investigate further.

Paul Whittaker

BATHROOMS & WETROOMS

DESIGN . SUPPLY . INSTALLATION



Tel: 07879 666221 . Website: www.paulwhittakerbathrooms.co.uk

Dunkley's
Chartered Accountants
30 YEAR ANNIVERSARY

HELPING YOU TO
**MAXIMISE
YOUR RETURN
ON EXIT**

TALK TO US ABOUT HOW WE CAN SUPPORT
YOU WITH SUCCESSION PLANNING

T: 01454 619900 E: ADVICE@DUNKLEYS.ACCOUNTANTS
WOODLANDS GRANGE, WOODLANDS LANE, BRADLEY STOKE, BS32 4JY

The sketch plan shows the golf course layout above and below Hazel Lane and includes the top of the Sheepcombe Valley. We assume that all the land was relatively open then, with few trees, although the 1888 plan shows parkland trees, some of which might still have been there, adding interest when the course was laid out. Natural hazards were incorporated into the design of this small, but quite tricky, nine-hole course.

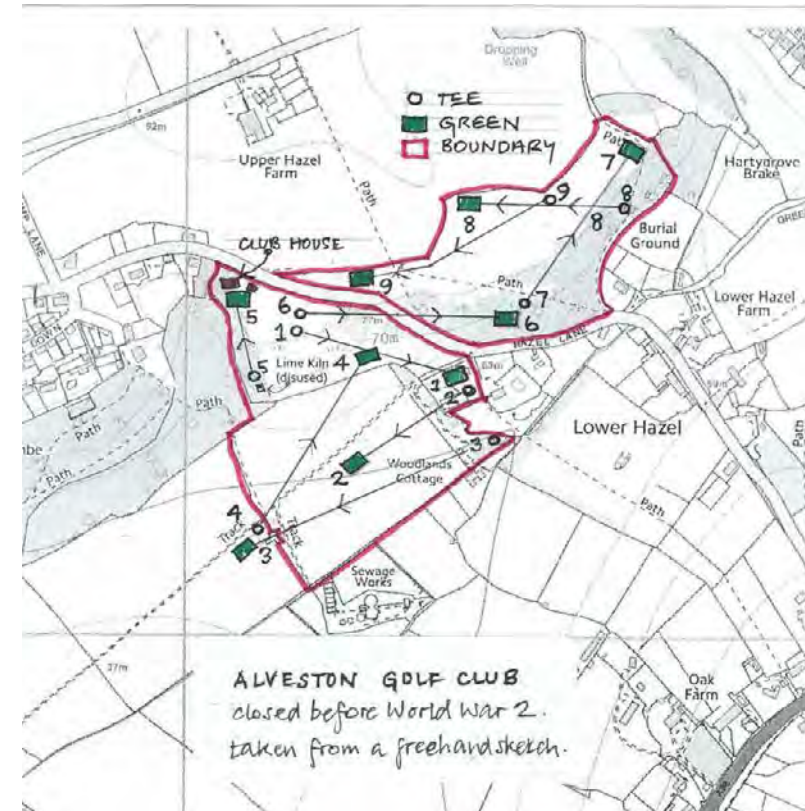

The Club House and associated buildings were at the top, adjacent to Hazel Lane. Hole 1 where the first clubhouse had been sited, is where a house is now. Hole 2 was a short drive down the valley towards Sheepcombe Farm. Tucked back into the easterly corner of what is now the lane down to a house in the valley bottom, was the tee for Hole 3, with a long drive down to the green on the far side of the cart pond, which formed a nasty, last minute water hazard. From a tee by the cart pond, Hole 4, was a long drive over rising ground to an invisible green. The tee for hole 5 looks as though it was adjacent to, or even off the top of, the disused limekiln at the bottom of

Maria Vizard - Tailor Made Tuition

Bespoke tutoring meeting the individual needs of your child.



For further information please contact me:
 Maria Vizard BEd Hons NPQSL QTS
 Email: Vizard243@btinternet.com
 Mobile: 07801983643/01454417255

- Primary age- Year 9
- Locally based but will consider travelling to you
- Competitive pricing: £15.00 for 30 mins or £25.00 per hour (discounts available for siblings/pre-paid block of sessions/pupils eligible for FSM)
- Fun and engaging sessions
- Developing a love for learning whilst nurturing a growth mindset
- Pre and Post Learning sessions offered
- Revision and entry exam preparation sessions available



Rebecca's Sewing Room

Seamstress all your sewing needs

01454 633905 | 07855745849
 33 Cross Hands Road, Pilning, Bristol BS35 4JB
rebeccadunsford@hotmail.co.uk
www.rebeccassewingroom.wordpress.com

Tavira
 Algarve, Portugal
 3 Bed Apartment
*can accommodate up to 8 people



Modern 3-bedroom apartment in picturesque & historic Algarve town. 2-bathrooms including one en-suite, 2-balconies & roof terrace. Fully furnished, sleeps 6-8. Easy walking to thriving town centre. Close to railway station, golf courses & beaches, 30 minutes drive from Faro. Ideal for families or golfers. Tel: 07889 727729
 Email: anthonyar@aol.com - www.amintpadtavira.co.uk



Lending with Heart and Mind

South Gloucestershire Council fund a not-for-profit loan scheme for homeowners and landlords*.

We understand the expense of maintaining your home and we work with you to take the stress out of funding repairs, improvements or adaptations.

We see you as an individual, not a credit score. Our knowledgeable team of advisers will guide you through the process of applying for a home improvement loan.

For a no-obligation assessment or more information visit
www.lendology.org.uk or call 01823 461099

Heatherton Park Studios, Bradford on Tone, Taunton, TA4 1EU

*subject to eligibility

Sheepcombe Brake, which would have been exciting, with the barrier of the long quarry wall to the right and an equally long, nerve wracking steep drop to the left, up towards the club house. Hole 6 teed off below the Club House with a long drive diagonally across Hazel Lane to the probably invisible green on the far side and requiring a watcher to warn motors and walkers. Hole 7 would have been invisible from the tee, over the hilltop, with the last hole 8, even worse! Hole 9 was a nice long flat drive back to the Clubhouse – but round the corner of the hedge, making even the last green invisible.

Somebody must recall early experiences or have records of this interesting and characterful - but lost - local golf club. If you have, do please let us know.

Dancing for Charity

Sharon Phillips School of Dancing has raised £4395 for the Children's Hospice South West.



We finally were able to film our show from April 2020, which was postponed due to Covid restrictions. The show involved nearly 200 children, aged from three years to 18, with tap, modern and ballet dancing. We are so proud of our students, who worked so hard, and although it wasn't the same as having an audience, the show was brilliant. We then streamed it to family and friends of

children in the dancing school. It was a huge success, and it was great to be able to show how talented our amazing dancers are, just in a slightly different way.

We always support a charity with our show, and this year we chose Children's Hospice South West, which does amazing work with families of children with life limiting conditions. Through the show, a raffle of hampers, zoom lessons and donations, we have raised £4335. I am so thankful to everyone who donated as it has been hard for charities to maintain their funding during the pandemic. It is great to be able to give such an amazing amount to a wonderful charity.

If anyone is interested in our classes, please visit:
www.sharonphillipsdance.co.uk or phone 07989652780.

gsharchitects



FREE CONSULTATION

For further information please contact us on:

info@gsharchitects.co.uk
www.gsharchitects.co.uk
Almondsbury, Bristol

07780 000220

Build without planning permission

Quality design service from
concept to completion

Planning, construction drawings and
contract administration service
tailored to suit you

Domestic, Commercial,
and Sustainable Architecture.

Experienced working with
Listed Buildings

Build your dream home in your
garden

Development Advice and Appraisal

3D Visualisation Services

RIBA



Improvements to Tennis and Netball Courts at Marlwood School

The Friends of Marlwood School (FOMS) are proud to showcase the work that has been done at Marlwood as part of a two-stage project to improve tennis and netball facilities at the school. The work was organised and funded as a joint project between the school and FOMS and entailed power cleaning and line marking by local contractor AP Thompson. Improvements to the courts has been a long-term objective for FOMS, ever since pupils placed this project on their wish-list of things that could be done to improve facilities at the school. Mr Richards, PE teacher at Marlwood School says: *"Over the 11 years that I have worked at Marlwood School, I have seen the tennis and netball courts unfortunately become slightly dilapidated. Mr Planter and I created a 2-stage plan to get these areas up to a good standard. Stage 1 (short term) was to power clean the area and repaint the lines. Stage 2 (longer term) is to replace the fences and the surface. I am so pleased to say that, with the support of FOMS, stage 1 has now been completed. The results are outstanding and most importantly several pupils have mentioned how much better the area looks now. The positive knock-on effect is that students are now asking "When are we going to play tennis?" as they are excited to use the area. We are so grateful that FOMS have the same ambitions as us in the school, that we all just want to make the school as good as possible for the students to learn."*



This photograph shows Mr Del Planter (Head Teacher, left) and Mr Matthew Richards (PE teacher, right) testing out the recently improved tennis and netball facilities at Marlwood School.

Our focus now moves to Stage 2, which is under development in collaboration with the school, FOMS and several local sporting bodies. One upcoming and exciting fundraising event we have planned for the next stage is that we have two Marlwood dads running the London Marathon in

October in aid of this project. Stay tuned for marathon updates and news of other fundraising events. If you would like to get involved, please email marlwoodfriends@gmail.com, or follow us on Facebook @Friends of Marlwood School.

New Passage Cat Kennels

Large Runs ~ Heated Chalets
Licensed Cattery
in Pilning

Tel: 01454 632 456
www.catkennels.co.uk



Design & Planning

Home Extensions - Change of Use - Floor Plans
Full Planning & Building Regs drawing service
Almondsbury based with successful local projects

contact Julian Lowther for friendly professional advice

t:0117 2591059 julian@jfl-planning.co.uk
m:0789 0179546 www.jfl-planning.co.uk

G.V.R PITCHER & SONS

The Yard
Haw lane
Olveston
Bristol



TEL: 01454 619299
MOB: 07989 208964

Property Care & Improvements

CAR - VAN - MINIBUS

**SELF DRIVE - LOW-COST - SHORT/LONG TERM
WIDE VEHICLE SELECTION - CONTRACT HIRE**

- Fully Comprehensive Insurance
- Extra-Low Off Peak Rates
- No Hidden Charges
- Breakdown Cover
- Cars
- Minibuses
- Transits
- Sprinters
- Lutons & Tail Lifts

THORNBURY SELF DRIVE HIRE

Established Over 20 Years

www.tsdhire.co.uk
Mob: 07768 232424
Email: info@tsdhire.co.uk

01454 414111

COOPER ROAD, THORNBURY IND. EST., THORNBURY, BRISTOL BS35 3UP

THORNBURY AUTOBODIES

Car & Commercial Body Repairs

- Crash Repair • Re-Sprays • Dent Repair
- Spray Booth Facilities • Full Body Jigging • Recovery
- Top Standard Of Work
- Fully Insured
- Insurance & Private Work

Courtesy Vehicles • Free Estimates • Over 25 Years Experience

THORNBURY
01454 419985

Email: thornburyautobodies.ps@gmail.com www.thornburyautobodies.co.uk
Cooper Road, Thornbury Industrial Estate, BS35 3UP

WJC

Plumbing & Tiling

Bathroom & Wet Room Design & Installations
Tiling • General Plumbing
Kitchen Installation • Plastering

Billy Cook
WJC Plumbing & Tiling

07748 085 920
wjcpumbing@outlook.com

Giving Carers a Crucial Break

Are you kind, compassionate, reliable and caring? You could make a difference to a family carer. Did you know 77% of family carers in South Gloucestershire have not had a break since the start of the pandemic? Carers look after a friend, family member or neighbour who couldn't manage without them. They often have to provide crucial care all day, every day, with little to no time for themselves. It's sometimes impossible for carers to leave the person they look after.

Local charity, Carers Support Centre, runs a carers' breaks service across South Gloucestershire. A trained volunteer sits with the cared-for person so that the carer can get out – maybe just to the shops, or to go for a walk. Local carers explain what the service means to them:

"The volunteer is absolutely wonderful. My husband has got on really well and she has a lot of patience. It means I can go to my club and meet up with friends and have a good chat. This gives me something to talk to my husband about when I get home." Audrey

"She's such a lovely person and we both enjoy her company. In the time that she sits I go and paint for a couple of hours. This is something that I have not managed to do in 5 years, and I find it very relaxing." Pat

If you live in/near South Gloucestershire and can regularly spare 2-3 hours (Monday to Friday) a week, or fortnightly, during the day, Carers Support Centre would really like to hear from you. No personal care is involved, and previous experience is not required.

Marilyn Crump, Volunteer Coordinator explains:

"A volunteer needs to be someone a carer can trust and who wants to build a relationship with the cared-for person. We take time to find out about and train volunteers so that we can match them carefully to a family. This means that carers can take a regular break in complete confidence that the person they care for will be happy and safe."

The charity provides their volunteers with induction, training, on-going support and travel expenses. All face-to-face activity is risk-assessed in line with Covid-19 guidelines and reviewed on a regular basis.

For more information, please contact Marilyn Crump, Volunteer Coordinator:
Email: volunteering@carerssupportcentre.org.uk Tel: 07840 818 316

To find out about the range of services that Carers Support Centre provides, visit their website: www.carerssupportcentre.org.uk



GARDEN MACHINERY SPECIALISTS
SALES, SERVICE AND SPARES

E-MAIL: themowerdoctor@hotmail.co.uk WEBSITE: www.themowerdoctor.net
ADDRESS: Unit 2-3 The Rearing Unit, Oldbury Lane, Oldbury-On-Severn, BS35 1RF
TELEPHONE: 01454 411 701







DEALERS FOR:









Thornbury Area Youth Music Trust

Thornbury Area Youth Music Trust is urgently seeking new Trustees to join its board. The charity provides high-quality music tuition and activities for children aged 4-18 through a successful music centre that sees more than 100 children coming together to have fun making music each week. The centre gives these young people the chance to play in small and large ensembles, with regular performances throughout the year.



The charity was set up by parents after the local authority closed the music centre that was run at Marlwood School, Alveston. In 2018 the centre moved to Manorbroom School, Thornbury, and was meeting there every term-time Saturday morning until Covid hit. Since then the children have been receiving online tuition and coming together virtually to play ensemble pieces.

"TAYM is run by parents, trustees and volunteers," said Nadya Webster, a parent and a trustee. "With the decline in musical opportunities in primary and secondary schools, it's really important to us that all the young people of our area have access to music on their doorstep at affordable prices without having to travel further afield."



optimus™

"Optimise your Health"

Please Enquire:

Tel: 01454 528608
Email: info@optimuscp.com
Web: optimuscp.com

49 The High Street, Thornbury, BS35 2AS

PHYSIOTHERAPY

CHIROPRACTIC

PODIATRY

CHIROPODY

OLDOWN

TREE SURGEONS

TREE SURGERY AND HEDGE MAINTENANCE

PROFESSIONAL. QUALIFIED. FULLY INSURED.

www.oldowntrees.org

Antony Leicester 07800512408 info@oldowntrees.org



EC COMPUTERS

Computer support and solutions for the home and business user.

- PC/laptop repairs
- Virus removal
- Wifi/broadband issues
- Sponsors of Olveston FC

How can we help? Tel: 01454 281 500 Web: www.eccomputers.co.uk

IT Support/Repairs Office Equipment Print Solutions Telecoms Cyber Security Managed Services Software/Database applications

YOUR PC GURU

COMPUTING FOR 'MERE' MORTALS

01454 616365

- Home visits
- Computer Repair
- Phone & Tablet setup
- Home Wireless & Broadband
- Smart Home Tech
- Complete Mac support

www.yourpcguru.co.uk
Technology Advice & Repairs

JC 4x4 Ltd SPECIALIST IN LANDROVER 
SERVICE • REPAIR WORK • DIAGNOSTICS • MOTS • OTHER VEHICLES WELCOME
CALL JAMES: 01454 261067 / 07966 086447



EDGE
HEATING
& PLUMBING
07307 727244

Free Quotes

Domestic	Radiant heating
Commercial	Boilers
Breakdowns/ call outs	Radiators
Servicing	Plumbing
Installations	
Warm air heating	LPG, natural gas, oil



www.edgeheatingandplumbing.com info@edgeheatingandplumbing.com

Several of the trustees have children that are now moving on to other things and so the charity is looking for new trustees to join the board. "Trustees do not need any music background and they do not need to be a parent of a child in the centre," says Kieran Donaghey, also a parent and trustee. "We are looking for anyone who can bring new ideas, help with the governance of the music centre and who believes it is important for young people to have access to music education."

A Head of Centre, Administrator and a Treasurer manage the centre along with our team of dedicated music tutors. Trustee board meetings take place around 8-10 times per year and are currently held on-line. The role of Trustee is a voluntary one, with trustees taking on a variety of shared responsibilities, dependent on their experience and preference.

The Trust is also currently recruiting for a Treasurer who is required to manage the TAYM bank accounts in accordance with the agreed activities of the trust. This is a paid, part-time position.



For more information about TAYM, please see www.thornbury-music.org. You can also search for Thornbury Area Youth Music on YouTube and see some of the children's online performances.

If you are interested in either the Treasurer or Trustee roles, please contact trustee.taym@gmail.com.

News from St. Mary's

Debbie Harries



Coffee Shop

We are delighted that our Coffee Shop will be starting again in the new venue of St Mary's Church Olveston! We would like to thank Olveston Stores very much for letting us use their premises over the last few years, however the shop is expanding, with so many more products, which is wonderful!

Therefore, we are looking forward to welcoming you into church every Thursday from August 5th, between 10am - 12pm during the school holidays and 9am - 12pm during term time. Coffee, tea and delicious cakes will be served!



Dave Webb

Painter - Decorator

07809 869149

01454 201640

*Reliable, professional, friendly service.
Please ask for your free quotation*



Squire Sweep

A chimney sweep service from
Michael Squire

Tel: 07504 253 467

Email: squiresweep@gmail.com

Visit: www.squiresweep.co.uk

MEDWAY DESIGNS Sewing & Alterations

- Bridal Wear •Alterations
- Evening Wear •Day Wear
- Soft Furnishings & re-upholstery

Ask about sewing lessons

Delivery & Collection Service Available

Lois Coulson

0117 969 1798 /

07950 396064

loiscoulson@ymail.com

14 Watch Elm Close, Bradley Stoke

Call now for a friendly personal service

Cookin' On Gas Ltd



Repairs & Sales of all
domestic appliances:



**Gas & Electric Cookers and Hobs
Washing Machines, Dishwashers
Tumble Dryers**

**www.cookinongas.co.uk
enquires@cookinongasltd.co.uk**

**Matt Cole
1 Olive Gardens Tel 01454 851545
Alveston Mob 07715 705670**

Bristol Sinfonietta

Sadly, we had to postpone this concert in July due to restrictions, but we are delighted to say this fantastic orchestra will back on Saturday September 18th for another evening of classical music.

Tickets £8. Please come and support these wonderful musicians who are playing this concert in aid of the Church Tower Fund.

Church Fete

We will be having our Fete on Saturday September 4th! This will be held on Church Hill between 2-5pm. It will be great to have a big village event again! So please put the date in your diary!

August Anagrams

This month's puzzle challenges you to work out these 10 anagrams of insects and other bugs which you can find in your garden. Some are viewed as pests; others are always very welcome.

See how many you can work out.....answers over the page!

PRIDES

BELFRY TUT

OF GRANDLY

DOWSE WOOL

ME BLUE EBB

RECALL TAPIR

DECEIT PEN

BADLY RID

I WAGER

FRY LANCE

MEMORIALS &
MONUMENTS



Supplied & Erected

NEIL VIZARD
01454 419108

BAMFIELD
TREE SERVICES
TREE SURGERY AND LOGS



www.bamfieldtreeservices.co.uk
07761 810483

prestige
event equipment hire

Supplying you with the best equipment to succeed!
CELEBRATIONS & CORPORATE EVENTS

CUTLERY, CHINA, GLASSWARE, LINEN, REFRIGERATION,
COOKING EQUIPMENT, BARBEQUES, FURNITURE & MORE

Fast and Efficient, we stock a wide variety of
equipment covering anything from
WEDDINGS to FESTIVALS.

For a FREE quote please call: 01179613170
info@prestigecateringhire.co.uk
www.prestigecatering.co.uk

HK **Harkell**
Building services

- MAINTENANCE
- BRICKWORK
- ROOFING
- FENCING
- REPAIRS
- PLASTERING
- CARPENTRY
- PATIO ETC

FOR A FREE QUOTATION PLEASE CALL
TEL: 01454 617110 MOBILE: 0787 6682546

Window Cleaning

07976 694744 - 0117 9085794



M. Gray Window Cleaning

Family run business for over 25 years
experience working in the Almondsbury,
Olveston, Aust areas - and nearby.

Email: mgwc1@hotmail.com

Anagram Answers

Spider
Butterfly
Dragonfly
Woodlouse
Bumble Bee
Caterpillar
Centipede
Ladybird
Earwig
Crane fly

Yours Faithfully

Roger Howell
Thornbury Quaker Meeting

People sometimes ask me what Quakers believe. This is a difficult question to answer as probably no two Quakers will give the same answer. Really Quakerism is more a way of life than a system of set beliefs, but I suppose most Quakers will agree to a fundamental belief that there is God in everyone and that it is our duty to seek out that quality in others.

The Quaker way of life is based on what are known as testimonies, the best known of which is the testimony of Peace, which includes not only the rejection of war as a means of settling disputes, but also all forms of violence. The other testimonies include Justice, Equality, Truth and Simplicity. These are all based on the teaching and way of life of Jesus of Nazareth. Recently a testimony of Concern for the Environment has been added to the list.

During the silent meetings for worship held by Quakers, someone may briefly speak about something that has moved them deeply, which usually has some relation to one or other of the testimonies, and in the silence that follows one can ponder the meaning to oneself, and what one can do about it.

Because Quakers do not insist on a set of beliefs yet have a deep respect for the beliefs of others, it makes it easy for members of other denominations to attend Quaker Meetings. Christians, Jews, Moslems, Hindus and others have all attended Quaker Meetings and been made to feel welcome. A few years ago, a former teacher at the Quaker School at Brummana in Lebanon, on returning to the school, was greeted by a group of her old pupils with the words – we are all Muslim Quakers now!

greenside
Landscaping

The Cottage, Hortham Lane,
Almondsbury, Bristol BS32 4JP

Greenside Landscaping can offer a wide range of services including:

**Artificial Grass ~ Brick & Block Driveways
Decking ~ Fencing & Gates
Garden Design ~ Patios & Paths
Planting ~ Ponds & Water Features
Turfing & Seeding ~ Walling**

We pride ourselves on flexibility and we strive to meet our client's requirements and budgets.

www.greenside-landscaping.co.uk
Tel: 01454 250648 Mob: 07980 384321
Email: paulbradburn@hotmail.com

BEDLAM
www.bedlambeds.com

- Free local delivery
- Free assembly
- Free disposal of your bed

Divans / Mattresses / Ottoman & Wall beds /
Memory foam & latex mattresses / Beds made
to measure / Pine, Metal & leather beds

**Open Tuesday to Friday: 9am-5pm
Saturday: 10am-3pm**

Visit our showroom: The Old Post Office
26a Gloucester Road, Rudgeway, Bristol,
BS35 3RY (by the speed camera)

01454 617 277 or 07887 853479

MORAS
Decorating Services

ANDREW MORAS
Quality Painting and Decorating Services

For your **FREE** no obligation quote contact Andrew:

07962069036

✉ andrew@morasdecorating.co.uk
www.morasdecorating.co.uk

Music Lessons for All
Guitar, Piano, Keyboard or Recorder

Contact highly qualified, experienced teachers
Andy & Maxine Warn

Tel: 07916 253267
Email: max@crotchet-factory.co.uk

Thornbury Stairlifts
SALES SERVICING & REPAIRS



- New & Re-conditioned Stairlifts & Warranty
- Removals & Relocations
- Free Surveys & Quotes – No Obligation
- Rentals for Straight Stairs

Independent, Professional & Friendly Advice
Over 24 years practical experience



Independent Stairlift Specialist
01454 413748 07833 318722
www.thornburystairlifts.co.uk

Church News

ST MARY the VIRGIN, OLVESTON

Aug 1	9.30am 6pm	Holy Communion CW Evensong	Rev David Bone Rev Ann Lloyd
Aug 8	9.30am 6pm	Matins BCP Holy Communion CW	Rev David Moss Rev Ann Lloyd
Aug 15	9.30am 6pm	Morning Prayer Holy Communion BCP	P Harrod & J McBride Rev David Moss
Aug 22	9.30am 6pm	Holy Communion CW Evensong	Rev Ann Lloyd Paul Harrod
Aug 29	9.30am 6pm	Holy Communion Evening Prayer CW	Rev David Bone Paul Harrod

Also, every Wednesday at 10am, Holy Communion.

Online services will continue at www.stmarysolveston.org.uk.

Also visit *Revs Rural* on YouTube, every week.

Contact: Rev David Moss 01454 415190 email: mossds@gmail.com

CHAPELRY OF ST JOHN, AUST

Aug 8	10am	Morning Prayer	Trevor Cook
Aug 22	10am	Holy Communion	Rev David Moss

Contact: Trevor Cook 01454 618442

Church Wardens: Jenn Dickens 632312 & Clive Roberts 632238

ST MARY DE MALMESBURY, LITTLETON-ON-SEVERN

Aug 8	9am	Morning Prayer	Mrs Tracey Black
Aug 22	9am	Holy Communion	Rev David Bone

Contact: Tracey Black 417660 & Tim Pyper 416422 /07802 419451

ST JOHN THE EVANGELIST, ELBERTON

Aug 8	9am	Morning Prayer	Mrs Judith Heybyrne
Aug 22	9am	Holy Communion	Rev David Moss

Contacts: Judith Heybyrne 616725 and John Gunnery 413225

OLVESTON AND TOCKINGTON METHODIST CHURCH

Aug 1	10am	Tock Ch	Morning Worship led by Mrs Brenda Isherwood
Aug 8	10am	Olv Ch	Morning Worship led by Mr Colin Blenkinsopp
Aug 15	10am	Tock Ch	Morning Worship led by Mr Jonathan Edwards
Aug 22	10am	Olv Ch	Morning Worship led by Ms Christine Jones
Aug 29	10am	Tock Ch	Morning Worship led by Mrs Rosalie Doyle

Contact: Rev Simon Edwards 418176 email: simon.edwards@methodist.org.uk

THE VINE House of Prayer, Pilning Street, Awkley BS35 4HL
At present, meeting at 11am every Sunday.

Contact: Mike and Barbara Matthews 07512 917229 or email: thevine_awkley@hotmail.com

THE OASIS CHURCH, OLD DOWN

Contacts: Jenny Parfitt jennyparfitt@ymail.com & Sue Tett stett56@hotmail.co.uk

AUST EVANGELICAL and LITTLETON EVANGELICAL CHURCHES

Contact: Danny Bamfield 01454 419324 email: danny@thebamfields.co.uk

HOLIDAY LET 6 BERTH HOLIDAY HOME



Central Heating . Double-Glazed
Private Beach . Fishing Trips . Cliff Walks
Restaurant . Bar . Live Entertainment
Indoor Pool . Kids Club
Shop . Cafe . Takeaway





(2 Bed, 1 Ensuite)



Tony Gardner
07889 727 729

RC CHURCH OF CHRIST THE KING, Thornbury -
Mass on Sundays at 9.30 and 10.30am
Contact: 01454 412223 www.ctk-thornbury.org.uk

SOCIETY OF FRIENDS (QUAKERS), Thornbury

Contact: Brian Hawkins 01454 854867 hawkinsb863@gmail.com

Looking Ahead to September

Saturday September 4th St. Mary's Olveston Church Fete

Saturday September 11th Jenner Jazz Quartet, United Reform Church

Saturday September 18th Bristol Sinfonietta, St. Mary's Church, Olveston



Contact details for any clubs or organisations in the Meeting Point area can be found in the Meeting Point Directory on the community website: www.olvostonandaust.com. If you would like to update your organisation's details, please email: meetingpointsecretary@olvostonandaust.com

Advertisements Neither Meeting Point, its editor, nor management committee accept any responsibility or give any guarantee in case of any dispute or claim as to quality, condition or delivery of commodities or services advertised in this magazine. It is not to be taken that publication implies recommendation. It is always advisable to check prices when ordering goods or services.

Views expressed by contributors are not necessarily those of the editor or Meeting Point magazine.

Copyright Meeting Point 2021. Copyright remains with the author(s) and Meeting Point. No part of this publication may be reproduced or transmitted in any form without the prior permission of the copyright owners.

Meeting Point is printed by Motion Printing Ltd.



OLVESTON STORES & POST OFFICE

NOW STOCKING - JON THORNER'S FULL RANGE

NEW COSTA EXPRESS MACHINE IN STORE

HOME DELIVERIES (NO MINIMUM SPEND)

NEWSPAPERS DELIVERED (SMALL CHARGE)

PAYZONE FACILITY FOR BILL PAYMENTS, GAS, AND ELECTRIC TOP UPS

OUR INSTORE POST OFFICE OFFERS A WIDE RANGE OF SERVICES

CAR TAX
BILL PAYMENTS
CURRENCY ORDERS
POSTAGE
A RANGE OF INSURANCES
&
MUCH MORE

01454 612269

olvestonstores@btconnect.com

BONDS *of* THORNBURY

INDEPENDENT ESTATE AGENTS



A truly local independent estate agency with over 40 years of experience and with unrivalled knowledge of the property market within Thornbury and South Gloucestershire.
Our caring sales business is based on our reputation, honesty and integrity.

Please contact: Rowena Moncrieffe
for further details...

14 The Plain, Thornbury

Tel No: 01454 858007

www.bondsofthornbury.co.uk

enquiries@bondsofthornbury.co.uk

